



St. Joseph Catholic Church

New Church Building Project
September 2025 Update



Agenda

- Timeline/Status Update
- “Must Have” Elements
- Site Plan (Base and Master Plan)
- Floor Plan
- Comparisons to Current Chapel Center
- Exterior/Interior Renderings
- Possible Enhancements

Timeline

- Site Option Analysis - March 2025 - **Completed**
- Schematic Design - late June 2025 – **Completed**
- Initial Design Cost Estimate – late June 2025 – **Completed**
- Town Halls with Parish to Share Initial Design - **Aug/Sept 2025**
- Design Development - **In Process July-Nov 2025**
- Town Halls to Share Final Design - Dec 2025
- Diocesan/Vatican Approvals – Dec/Jan/Feb 2026
- Construction Documents - February 2026
- Complete Construction Bidding - April/May 2026
- **Construction Begins - June 2026 – Projecting 18 months**

New Church Design “Must Haves”

1. Pew seating capacity must be greater than 800, with overflow seating available (add chairs in Nave and Narthex) to bring total seating to 1,200.
2. Two confessionals capable of behind-the-screen or face-to-face confessions.
3. Sufficient Restrooms.
4. Separate sacristies for clergy, servers and work sacristy. The work sacristy should be near the altar. The size of the sacristies must be larger than in our current building.
5. The number of parking spaces must not be reduced.
6. A narthex at the entrance of the church must be larger than the current “Great Hall” space and must consider the need for events like Coffee and Donuts after Masses.
7. The sanctuary (altar area) at least equal in size as our current but also have extra room in front of the altar so an ordination could take place in the future.
8. Expandability-- church must be designed in such a way that it can be expanded later to a pew seating capacity of 1,200, include a future Adoration Chapel and other rooms.

New Church Design “Must Haves”

1. Pew seating capacity must be greater than 800, with overflow seating available (add chairs in Nave and Narthex) to bring total seating to 1,200.
2. Two confessionals capable of behind-the-screen or face-to-face confessions.
3. Sufficient Restrooms
4. **And meet \$11.0 million construction budget**
5. The number of parking spaces must not be reduced.
6. A narthex at the entrance of the church must be larger than the current “Great Hall” space and must consider the need for events like Coffee and Donuts after Masses.
7. The sanctuary (altar area) at least equal in size as our current but also have extra room in front of the altar so an ordination could take place in the future.
8. Expandability-- church must be designed in such a way that it can be expanded later to a pew seating capacity of 1,200, include a future Adoration Chapel and other rooms.

Base Plan

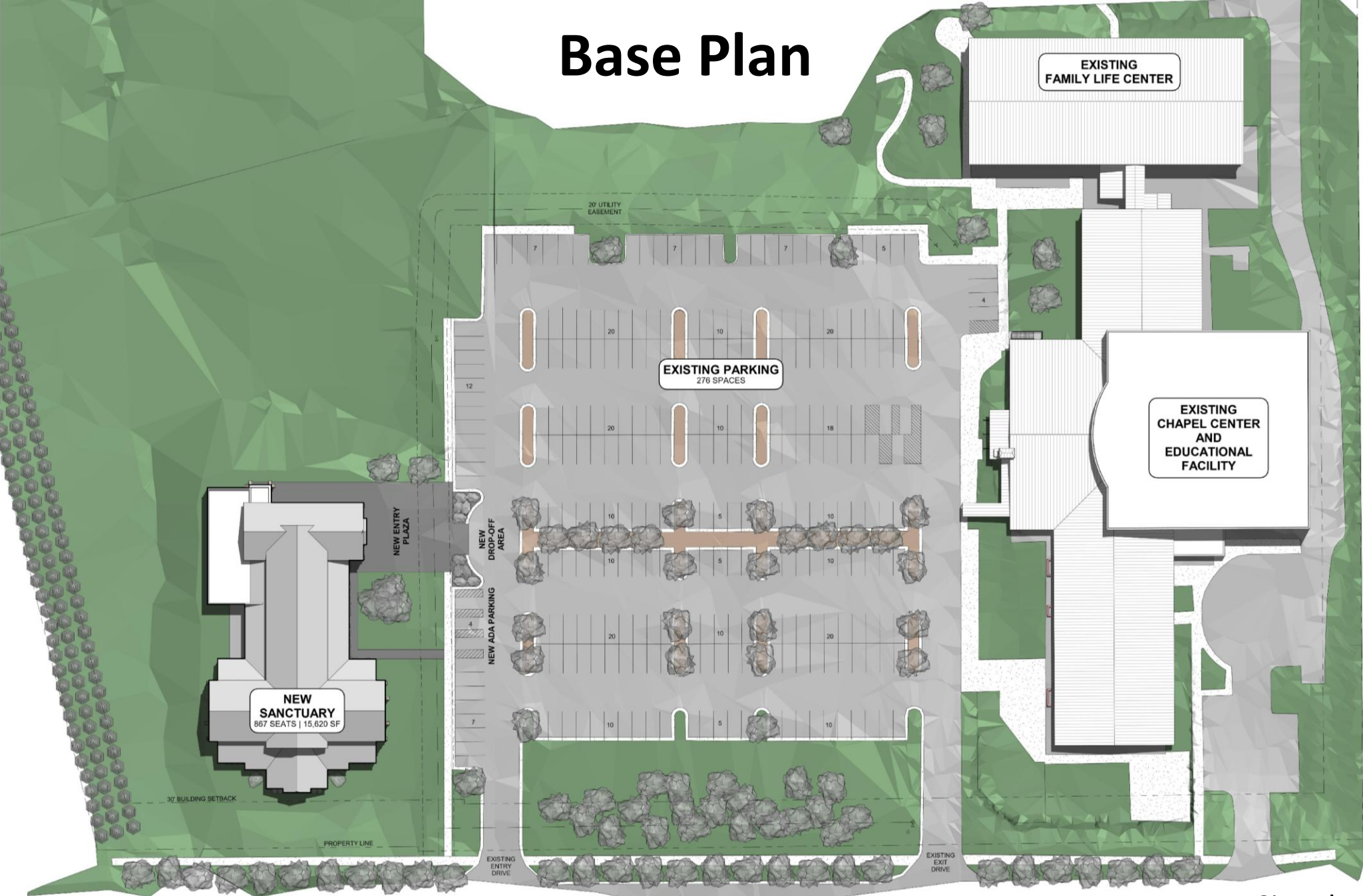

Master Site Plan



Future:

- Adoration Chapel
- Bell Tower
- Parish Hall
- Church Expansion
- Additional Parking
- Walkways

New Church Design – Floor Plan

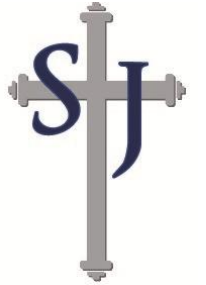

Key Elements:

- Seats 867 incl. choir and ADA seating
- Additional chair seating of ~350 in Nave and Narthex
- Nave (10,103 sq ft)
- Large Narthex (1,925 sq ft) – with clear visibility to Nave/altar
- Two confessionals – private or face to face
- Elevated Altar
- Large priest sacristy & separate server and work sacristies
- Choir located in right transept area, near altar
- Restrooms – 6 stalls women, 4 urinals/2 stalls men, 1 family

Star Drive



Floor Plan – 15,620 Sq Ft with 867 Seats



Structure Dimensions Comparisons

New Church vs Current

New Church Base	Current Chapel Center
Base Pew Seating*/ With Added Chairs*= 867 / ~1200	Base Pew Seating*/With Corry Hall/ Max Capacity = 567/738/999
Total Nave = 10,103 sq ft Narthex = 1,925 sq ft (outside Nave) Total building = 15,620 sq ft	Chapel Center ex Corry Hall = 6,179 sq ft w/Corry Hall Folding Doors open = 9,439 sq ft
Interior Ceiling – 37.5' at peak	Interior Ceiling – 27' at peak
Center Aisle / Side Aisle Widths = 8.0 ft / 5.0 ft	Center Aisle / Side Aisle Widths = 7.0 ft / 4.0 ft

**based on 21" per person linear seating area*





Campus Birdseye
Perspective – Northeast



Campus Birdseye
Perspective – Southwest



Exterior Perspective at Starr Drive



Exterior Perspective at Entry Drive



Exterior Perspective at Entry Plaza



Exterior Perspective at Southeast Corner



Interior Perspective at Narthex



Interior Perspective at Nave



Interior Perspective at Altar



Interior Perspective at Transept



Interior Perspective from Altar

What Happens to Current Chapel Center Space?

- Although not in the scope of New Church Building Committee, options are under consideration for repurposing the chapel center space to benefit both the church and school.
- Options include large multi-purpose room, expanded Adoration chapel, additional meeting rooms and offices.
- No formal decisions or plans have been made at this point.
- Initial funding for the repurposing is being raised via several school events (Men's Night, Gala, etc.)
- Father Tyler is working with Pastoral Council and school leadership on next steps.

Design Changes Made to Meet Budget

- Meeting budget of \$11.0 million required design adjustments
- Eliminated Bell Tower and Colonnade elements
- If possible, we would like to add those elements back in
- Requires an estimated \$1 million in additional funding
- Equivalent to 1 additional year of pledge payments



Exterior Perspective at Entry Plaza



Exterior Perspective at Entry Plaza



Exterior Perspective at Southeast Corner



Exterior Perspective at Southeast Corner

Northwest
Isometric



Southwest
Isometric



Southeast Isometric



Northwest Isometric



Father Tyler



St. Joseph
Catholic Church

Final Questions?